

**KEY**

- Land to be acquired
- Shared path
- Land over which a temporary possession or other rights in kind to be acquired. Shaded green to indicate Shared Way
- Land over which servitudes or other rights in kind to be acquired. Shaded green to indicate Shared Way

**Note:** Different shades of colour have been used on the Map to differentiate between adjacent plots of the same colour as a higher ton typically in between boundaries.

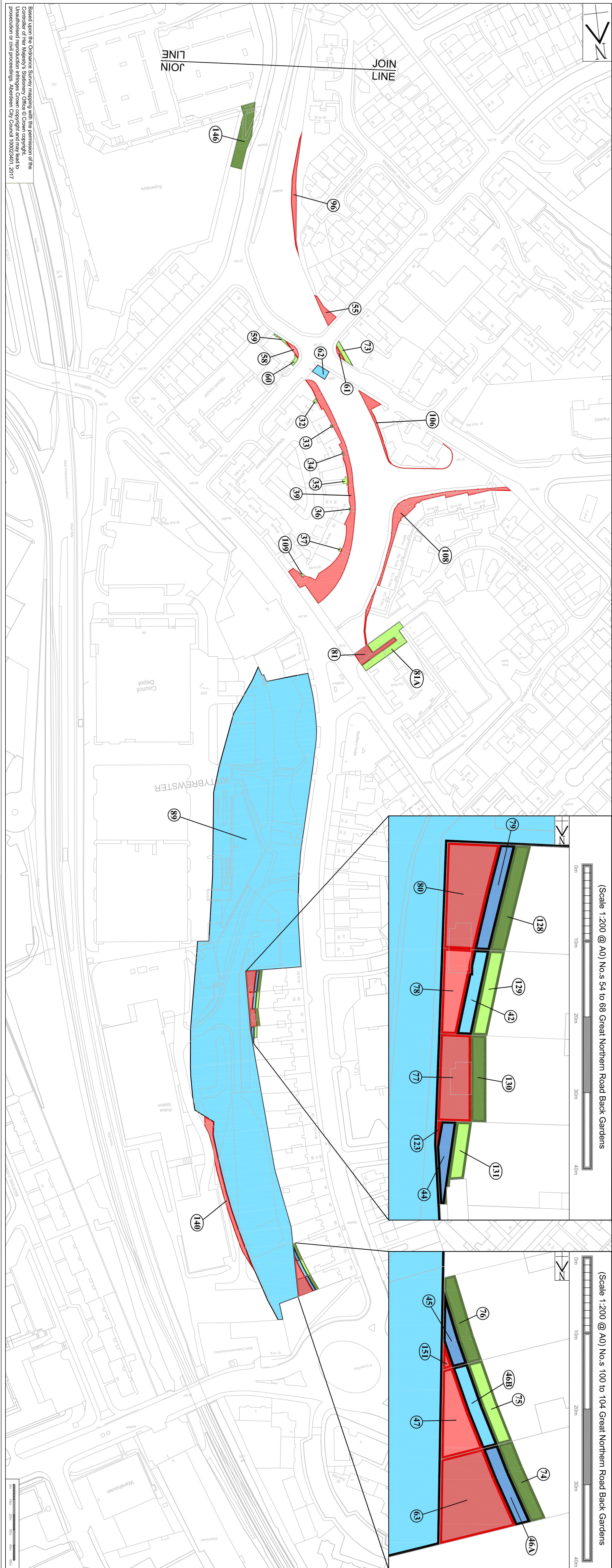

(Scale 1:200 @ A0) Nos 54 to 68 Great Northern Road Back Gardens

(Scale 1:200 @ A0) Nos 100 to 104 Great Northern Road Back Gardens

<p><b>ABERDEEN CITY COUNCIL</b></p> <p>Communities, Housing &amp; Infrastructure Marischal College, Broad Street, Aberdeen, AB10 1AB</p> <p>Client: <b>ABERDEEN CITY COUNCIL</b></p> <p>Project: <b>BERRYMEN CORRIDOR IMPROVEMENT</b></p> <p>Title: This is the Map referred to in The Aberdeen City Council (Berrymen Corridor Improvement) Compulsory Purchase Order 2017</p> <p>Drawn (Ref: 281117) Checked (Ref: 281117) M.M. 28/11/17 W.F. 28/11/17</p> <p>Drawn (Ref: 11900) Checked (Ref: 11900) M.M. 28/11/17 W.F. 28/11/17</p>	<p><b>ABERDEEN CITY COUNCIL</b></p> <p>Communities, Housing &amp; Infrastructure Marischal College, Broad Street, Aberdeen, AB10 1AB</p> <p>Client: <b>ABERDEEN CITY COUNCIL</b></p> <p>Project: <b>BERRYMEN CORRIDOR IMPROVEMENT</b></p> <p>Title: This is the Map referred to in The Aberdeen City Council (Berrymen Corridor Improvement) Compulsory Purchase Order 2017</p> <p>Drawn (Ref: 281117) Checked (Ref: 281117) M.M. 28/11/17 W.F. 28/11/17</p> <p>Drawn (Ref: 11900) Checked (Ref: 11900) M.M. 28/11/17 W.F. 28/11/17</p>
---	---

Based upon the Ordnance Survey map with the permission of the Controller of Her Majesty's Stationery Office © Crown copyright. Unauthorised reproduction infringes Crown copyright and may lead to prosecution or civil proceedings. Aberdeen City Council 10/2020/11/17